

Specification Sheet

Base Cabinet with Full Height Door

Available Models:

B-9	1 Door	R/L
B-12	1 Door	R/L
B-15	1 Door	R/L
B-18	1 Door	R/L
B-21	2 Door	--
B-24	2 Door	--
B-27	2 Door	--
B-30	2 Door	--
B-33	2 Door	--
B-36	2 Door	--



Any width available from 9 Inch to 36 Inch, and in any fraction of an inch.

Base Cabinets with Full Height Door are designed standard with two adjustable shelves and have either one or two doors depending upon width. Additional shelves and even pull-out trays (up to 30" wide) can be added for specialty storage and added functionality to meet your needs.

Top View

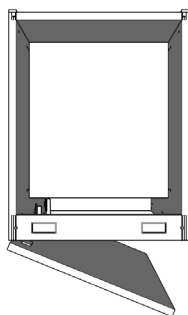

Front View

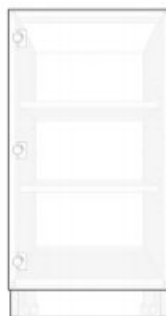

Standard Height: 34.75" overall (31" box)
Standard Depth: 24" overall (23" box)

Available Modifications:

Extend Side Panel (L/R)	+12"
Increase Height	+6"
Decrease Height	-6"
Decrease Width	-3"
Increase Depth	+12"
Decrease Depth	-12"

Add Shelf (up to 36"W)	+1
Add Pull-Out Tray (up to 30"W)	+3

Side View



3-D View



Visit www.werever.com to view available colors and door styles for all cabinets.

All Werever Outdoor Cabinets are constructed from solid, $\frac{3}{4}$ " high-density polyethylene.

Specification Sheet

Base Cabinet with Top Drawer

Available Models:

B-9-D	1 Door	R/L
B-12-D	1 Door	R/L
B-15-D	1 Door	R/L
B-18-D	1 Door	R/L
B-21-D	2 Door	--
B-24-D	2 Door	--
B-27-D	2 Door	--
B-30-D	2 Door	--

Any width available from 9 Inch to 30 Inch, and in any fraction of an inch.



A Base Cabinet with Top Drawer is the most common style cabinet in any kitchen. The top drawer provides great storage for grilling tools, utensils, foil, mitts and other accessories, while an adjustable behind the doors provides storage space for larger items. Add pull-out trays for ease of access to items stored below or remove the adjustable shelf to storage larger or taller items.

Top View

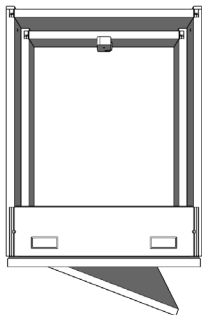

Front View



Standard Height: 34.75" overall (31" box)
Standard Depth: 24" overall (23" box)

Available Modifications:

Extend Side Panel (L/R)	+12"
Increase Height	+6"
Decrease Height	-6"
Decrease Width	-3"
Increase Depth	+12"
Decrease Depth	-12"

Add Shelf (up to 30"W)	+1
Add Pull-Out Tray (up to 30"W)	+3

Side View



3-D View



Visit www.werever.com to view available colors and door styles for all cabinets.

All Werever Outdoor Cabinets are constructed from solid, 3/4" high-density polyethylene.

Specification Sheet

Sink Base Cabinet with False Face

Available Models:

SB-9	1 Door	R/L	SB-36	2 Door	--
SB-12	1 Door	R/L	SB-39	2 Door	--
SB-15	1 Door	R/L	SB-42	4 Door	--
SB-18	1 Door	R/L	SB-45	4 Door	--
SB-21	2 Door	--	SB-48	4 Door	--
SB-24	2 Door	--	SB-51	4 Door	--
SB-27	2 Door	--	SB-54	4 Door	--
SB-30	2 Door	--	SB-57	4 Door	--
SB-33	2 Door	--	SB-60	4 Door	--



Any width available from 9 Inch to 60 Inch, and in any fraction of an inch.

Sink Base Cabinets are used to accommodate most any drop-in or undermount sink (for Apron-front or Farmhouse-style sinks, see *Grill Cabinets*), and may also be used below drop-in coolers, drop-in side burners, cooktops, and other drop-in style appliances without face controls. Larger sink bases can also be used to store oversized items including chair cushions and pool noodles.

Top View

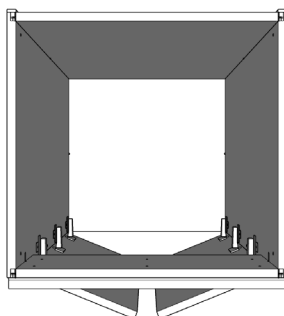

Front View

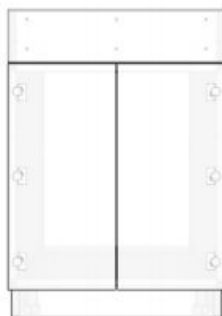

Standard Height: 34.75" overall (31" box)
Standard Depth: 24" overall (23" box)

Available Modifications:

Extend Side Panel (L/R)	+12"
Increase Height	+6"
Decrease Height	-6"
Decrease Width	-3"
Increase Depth	+12"
Decrease Depth	-18"

Add Shelf (up to 36"W)*	+2
Add Pull-Out Tray (up to 30"W)*	+2

**NOTE: Shelves and Pull-Out Trays in Sink Cabinets may interfere with utilities below the sink or other appliance. Consult with your Account Manager for inclusion of these items in your specific design.*

Side View



3-D View



Visit www.werever.com to view available colors and door styles for all cabinets.

All Werever Outdoor Cabinets are constructed from solid, 3/4" high-density polyethylene.

Specification Sheet

Sink Base Cabinet with Full Height Door

Available Models:

SBFH-9	1 Door	R/L	SBFH-36	2 Door	--
SBFH-12	1 Door	R/L	SBFH-39	2 Door	--
SBFH-15	1 Door	R/L	SBFH-42	4 Door	--
SBFH-18	1 Door	R/L	SBFH-45	4 Door	--
SBFH-21	2 Door	--	SBFH-48	4 Door	--
SBFH-24	2 Door	--	SBFH-51	4 Door	--
SBFH-27	2 Door	--	SBFH-54	4 Door	--
SBFH-30	2 Door	--	SBFH-57	4 Door	--
SBFH-33	2 Door	--	SBFH-60	4 Door	--



Any width available from 9 Inch to 60 Inch, and in any fraction of an inch.

Sink Base Cabinets are used to accommodate most any drop-in or undermount sink (for Apron-front or Farmhouse-style sinks, see *Grill Cabinets*), and may also be used below drop-in coolers, drop-in burners, cooktops, and other appliances without face controls. The Full Height Door style sink base conceals a 6" tall apron behind doors at top and coordinates well with a continuous run of all full height door cabinets.

Top View

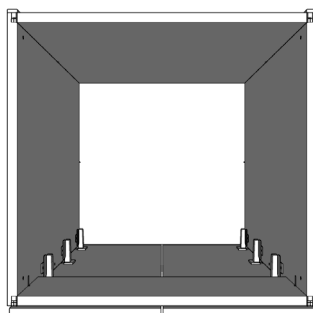

Front View

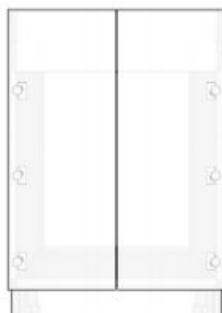

Standard Height: 34.75" overall (31" box)
Standard Depth: 24" overall (23" box)

Available Modifications:

Extend Side Panel (L/R)	+12"
Increase Height	+6"
Decrease Height	-6"
Decrease Width	-3"
Increase Depth	+12"
Decrease Depth	-18"

Add Shelf (up to 36"W)*	+2
Add Pull-Out Tray (up to 30"W)*	+2

**NOTE: Shelves and Pull-Out Trays in Sink Cabinets may interfere with utilities below the sink or other appliance. Consult with your Account Manager for inclusion of these items in your specific design.*

Side View



3-D View



Visit www.werever.com to view available colors and door styles for all cabinets.

All Werever Outdoor Cabinets are constructed from solid, 3/4" high-density polyethylene.

Specification Sheet

ADA Sink Base Cabinet

Available Models:

ADA-SB-36
ADA-SB-39

Any width available from 36 Inch to 39 Inch, and in any fraction of an inch. This cabinet may be modified to a smaller than 36" width upon special request.



ADA Sink Base Cabinets are designed for accessibility. This cabinet model may be used with any compatible drop-in or undermount sink supported by your countertop.

An additional panel to be used as pipe/P-Trap cover may be ordered as an add-on accessory and must be specified as an additional item. Please consult with your Account Manager for additional information.

Top View

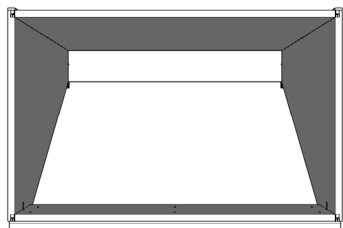

Front View

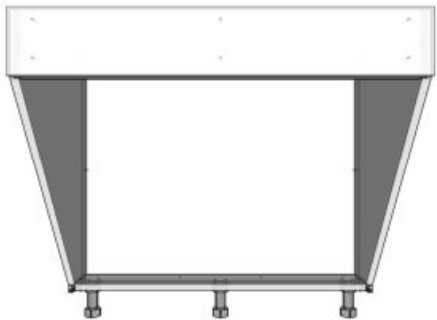

Standard Height: 32.5" overall (28.75" box)
Standard Depth: 24" overall (23" box)

Available Modifications:

Extend Side Panel (L/R)	+12"
Increase Height	+8.25"
Decrease Height	-3.75"
Decrease Width	-3"
Increase Depth	+6"
Decrease Depth	-12"

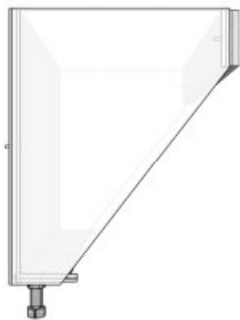

Side View



3-D View

NOTE: Some modifications to the ADA Sink Base Cabinet may not meet the Standards of the Americans with Disability Act. Please consult the published ADA Standards for Accessible Design at www.ada.gov.

Visit www.werever.com to view available colors and door styles for all cabinets.

All Werever Outdoor Cabinets are constructed from solid, 3/4" high-density polyethylene.

Specification Sheet

Pull-Out Trash Cabinet with Full Height Door

Available Models:

TC-15	Single Can
TC-18	Single Can
DTC-20	Double Can
DTC-21	Double Can

Single Pull-Out Trash available in any width from 15 Inch to 18 Inch, and Double Pull-Out Trash available from 20 Inch to 21 Inch wide.

Can(s) included.



Adding a Pull-Out Trash Cabinet to your Outdoor Kitchen creates convenience. Whether hosting a gathering or preparing a meal for you and your family, easy access to the Pull-Out Trash makes clean-up a breeze. Position a Pull-Out Trash Cabinet near a sink for easy clean-up, or at the end of a cabinetry run for easy access for your guests to dispose of trash and recyclables.

Top View

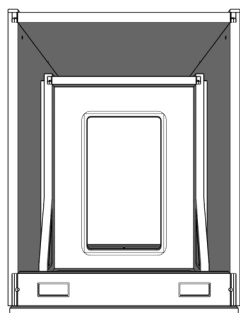

Front View



Standard Height: 34.75" overall (31" box)
Standard Depth: 24" overall (23" box)

Available Modifications:

Extend Side Panel (L/R)	+12"
Increase Height*	+6"
Decrease Height	-6"
Increase Depth	+12"

**NOTE: Height of DTC-20, DTC-21 may not be increased; please use DTC-20-D, DTC-21-D for taller cabinet if height increase is required for project needs.*

Side View



3-D View



Visit www.werever.com to view available colors and door styles for all cabinets.

All Werever Outdoor Cabinets are constructed from solid, 3/4" high-density polyethylene.

Specification Sheet

Pull-Out Trash Cabinet with Top Drawer

Available Models:

TC-15-D	Single Can
TC-18-D	Single Can
DTC-20-D	Double Can
DTC-21-D	Double Can

Single Pull-Out Trash available in any width from 15 Inch to 18 Inch, and Double Pull-Out Trash available from 20 Inch to 21 Inch wide.

Can(s) included.



Adding a Pull-Out Trash Cabinet to your Outdoor Kitchen creates convenience. Whether hosting a gathering or preparing a meal for you and your family, easy access to the Pull-Out Trash makes clean-up a breeze. Position a Pull-Out Trash Cabinet near a sink for easy clean-up, or at the end of a cabinetry run for easy access for your guests to dispose of trash and recyclables.

Top View

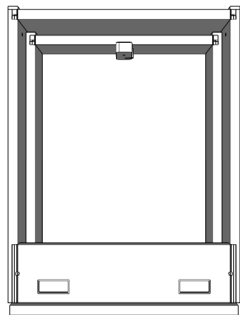

Front View



Standard Height: 34.75" overall (31" box)
Standard Depth: 24" overall (23" box)

Available Modifications:

Extend Side Panel (L/R)	+12"
Increase Height	+6"
Increase Depth	+12"



Side View



3-D View

Visit www.werever.com to view available colors and door styles for all cabinets.

All Werever Outdoor Cabinets are constructed from solid, 3/4" high-density polyethylene.

Specification Sheet

Pull-Out LP Tank Cabinet

Available Models:

LPC-18	L/R
LPC-18-D	L/R

LP Tank Cabinet available with Full-Height Door (LPC-18), or with Top Drawer (LPC-18-D).

Fixed width at 18" wide.



The Pull-Out LP Tank Cabinet stores a standard size 5G/25lb LP gas tank for your Grill, Side Burner, or other gas cooking appliance. Position this cabinet adjacent to or between the gas appliance cabinets in your design plan. The pull-out feature makes tank exchange or refill easy. A top drawer added to this cabinet provides additional storage space for grilling tools or utensils right where they are needed most.

Top View

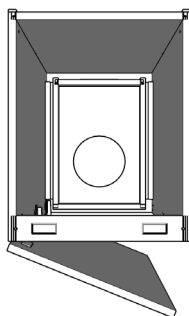

Front View



Standard Height: 34.75" overall (31" box)
Standard Depth: 24" overall (23" box)

Available Modifications:

Extend Side Panel (L/R)	+12"
Increase Height	+6"
Decrease Height*	-6"
Increase Depth	+6"

**NOTE: Decrease height of the LPC-18 cabinet only (cannot decrease height of LP Tank Cabinet with Top Drawer).*

Side View



3-D View



Visit www.werever.com to view available colors and door styles for all cabinets.

All Werever Outdoor Cabinets are constructed from solid, 3/4" high-density polyethylene.



Specification Sheet

3-Drawer Base Cabinet

Available Models:

- DB-9-3
- DB-12-3
- DB-15-3
- DB-18-3
- DB-21-3

Any width available from 9 Inch to 21 Inch, and in any fraction of an inch.



Drawer Base Cabinets are often the most functional cabinets in an outdoor kitchen. The 3-Drawer Base provides a top drawer for small items, and two deep drawers for larger items such as pots, pans, and larger grilling tools. Position a Drawer Base Cabinet near your cooking areas for easy access to your utensils and accessories.

Top View

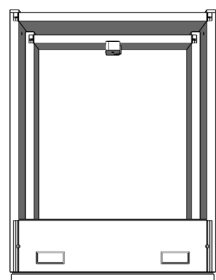

Front View

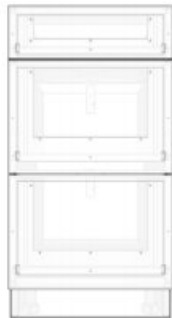

Standard Height: 34.75" overall (31" box)
Standard Depth: 24" overall (23" box)

Available Modifications:

Extend Side Panel (L/R)	+12"
Decrease Height	-6"
Decrease Width	-3"
Increase Depth	+12"
Decrease Depth	-9"

Special Modification:

Request for the top drawer of this cabinet to be a false face and install this cabinet below a drop-in Side Burner for additional drawer utility in your outdoor kitchen.

Reference Models:

SB-9-2, SB-12-2, SB-15-2, SB-18-2, SB-21-2

Visit www.werever.com to view available colors and door styles for all cabinets.



Side View



3-D View

All Werever Outdoor Cabinets are constructed from solid, $\frac{3}{4}$ " high-density polyethylene.

Specification Sheet

4-Drawer Base Cabinet

Available Models:

DB-12-4
DB-15-4
DB-18-4
DB-21-4
DB-24-4
DB-27-4

Any width available from 12 Inch to 27 Inch, and in any fraction of an inch.



Drawer Base Cabinets are often the most functional cabinets in an outdoor kitchen. The 4-Drawer Base provides a top drawer for small items, and three equal sized drawers below for utensils, mitts, grill tools, foil, paper towels, and more. Position a Drawer Base Cabinet near your cooking areas for easy access to your utensils and accessories.

Top View

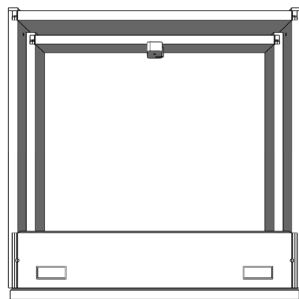

Front View



Standard Height: 34.75" overall (31" box)
Standard Depth: 24" overall (23" box)

Available Modifications:

Extend Side Panel (L/R)	+12"
Increase Height	+6"
Decrease Height	-6"
Decrease Width	-3"
Increase Depth	+12"
Decrease Depth	-9"

Special Modification:

Request for the top drawer of this cabinet to be a false face and install this cabinet below a drop-in Side Burner for additional drawer utility in your outdoor kitchen.

Reference Models:

SB-12-3, SB-15-3, SB-18-3,
SB-21-3. SB-24-3, SB-27-3

Visit www.werever.com to view available colors and door styles for all cabinets.



Side View



3-D View

All Werever Outdoor Cabinets are constructed from solid, 3/4" high-density polyethylene.

Specification Sheet

Open Base Cabinet

Available Models:

OB-9
OB-12
OB-15
OB-18
OB-21
OB-24
OB-27
OB-30

*Any width available from
9 Inch to 30 Inch, and in
any fraction of an inch.*



Open Base Cabinets can serve a variety of purposes in your outdoor kitchen. This cabinet style is great for decorative items on display, unique baskets or bins that coordinate with your décor, and even added under-counter workspace to place items if the countertop is crowded when cooking and serving. Shelves are adjustable and removeable, and additional shelves can be added to meet your needs.

Top View

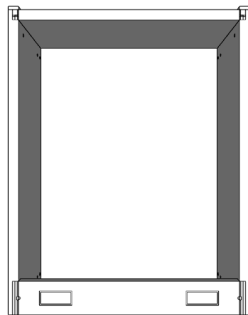

Front View

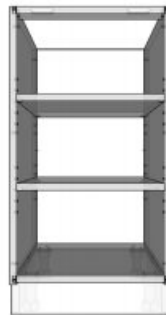

Standard Height: 34.75" overall (31" box)
Standard Depth: 24" overall (23" box)

Available Modifications:

Extend Side Panel (L/R)	+12"
Increase Height	+6"
Decrease Height	-6"
Decrease Width	-3"
Increase Depth	+12"
Decrease Depth	-18"
Add Shelf (up to 30"W)	+1



Side View



3-D View

Visit www.werever.com to view available colors and door styles for all cabinets.

All Werever Outdoor Cabinets are constructed from solid, 3/4" high-density polyethylene.

WEREVER OUTDOOR CABINETRY



Specification Sheet

Grill Cabinet

Available Models:

DG-27	2 Door
DG-30	2 Door
DG-33	2 Door
DG-36	2 Door
DG-39	2 Door
DG-42	4 Door
DG-45	4 Door
DG-48	4 Door
DG-51	4 Door
DG-54	4 Door
DG-57	4 Door
DG-60	4 Door
DG-63	4 Door



Grill Cabinets are cut and built to order, with face plate, doors, and support structures designed and cut specifically for your Grill model and your countertop thickness. **Every Grill installed in a Werever Cabinet requires an Insulating Jacket for combustible enclosures from the Grill Manufacturer.**

Some Grills allow for a Warming Drawer to be installed in the cabinet below. Alternatively, a Warming Drawer can be installed in the top face panel of a separate Grill Cabinet. Consult with your Account Manager for more information on Grill Cabinets and important Appliance specifications.

Any width available from 27 Inch to 63 Inch (64" wide available as needed). Overall size of the Grill Cabinet is determined based on the cut-out and clearance specifications from the Grill and Insulating Jacket Manufacturer. Consult with your Account Manager for the correct size Grill Cabinet.

Top View

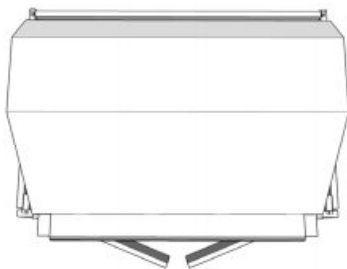

Front View



Standard Height: 34.75" overall (31" box)
Standard Depth: 27" overall (26" box)*

**NOTE: Most Grills with Insulating Jackets will require a 27-30" deep cabinet. Consult with your Account Manager for the correct size Grill Cabinet for your specified Appliances.*

Available Modifications:

Extend Side Panel (L/R)	+12"
Increase Height	+6"
Decrease Height	-6"
Decrease Width	-3"
Increase Depth	+12"
Decrease Depth	-3"

Side View

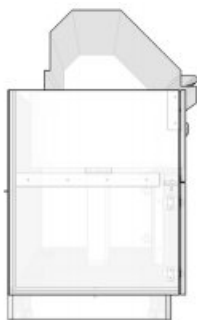

3-D View



Visit www.werever.com to view available colors and door styles for all cabinets.

All Werever Outdoor Cabinets are constructed from solid, ¾" high-density polyethylene.



Specification Sheet

Side Burner Cabinet

Available Models:

- SIDE-15 1 Door
- SIDE-18 1 Door
- SIDE-21 2 Door
- SIDE-24 2 Door

Any width available from 15 Inch to 24 Inch, and in any fraction of an inch.

For larger Burner units and Power Burners, a Grill Cabinet may be required.



Side Burner Cabinets are cut and built to order, with face plate, doors, and support structures designed and cut specifically for your Burner model and your countertop thickness. **Some Burners installed in a Werever Cabinet will require an Insulating Jacket for combustible enclosures from the Grill Manufacturer.**

Consult with your Account Manager for the correct size Side Burner Cabinet.

Top View

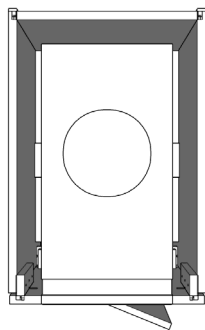

Front View

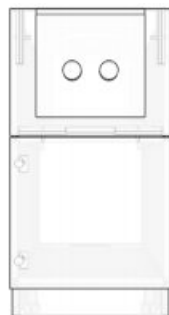

Standard Height: 34.75" overall (31" box)
Standard Depth: 27" overall (26" box)*

**NOTE: Most Side Burners will require a 27-30" deep cabinet. Consult with your Account Manager for the correct size Side Burner Cabinet for your specified Appliances.*

Available Modifications:

Extend Side Panel (L/R)	+12"
Increase Height	+6"
Decrease Height	-6"
Decrease Width	-3"
Increase Depth	+12"
Decrease Depth	-3"

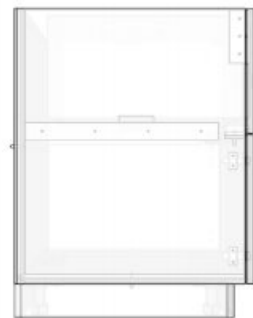

Side View



3-D View

Visit www.werever.com to view available colors and door styles for all cabinets.

All Werever Outdoor Cabinets are constructed from solid, 3/4" high-density polyethylene.

Specification Sheet

Side Burner Cabinet with Drawers

Available Models:

SIDE-15-2
SIDE-18-2
SIDE-21-2
SIDE-24-2

Any width available from 15 Inch to 24 Inch, and in any fraction of an inch.

Consult with your Account Manager for the correct size Side Burner Cabinet for your appliance.

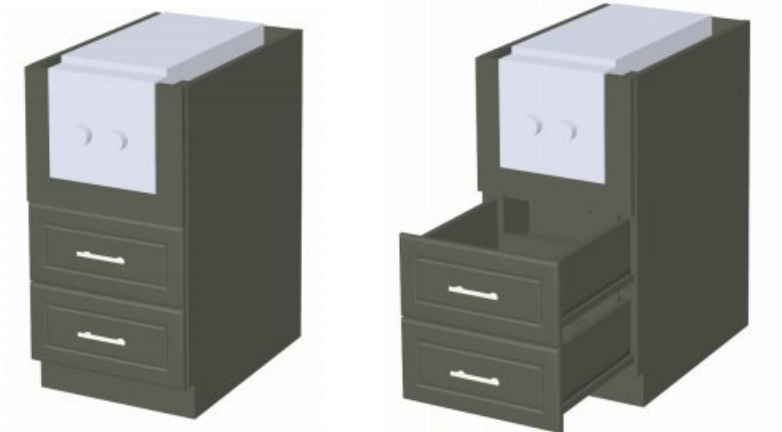

Side Burner Cabinets are cut and built to order, with face plate, doors, and support structures designed and cut specifically for your Burner model. **Some Burners installed in a Werever Cabinet will require an Insulating Jacket for combustible enclosures from the Grill Manufacturer.**

Top View

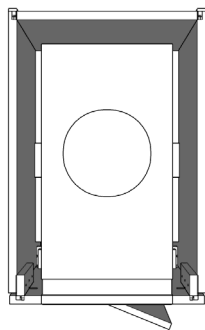

Front View

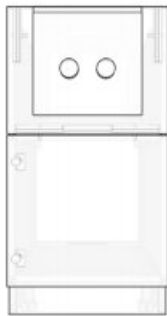

Standard Height: 34.75" overall (31" box)
Standard Depth: 27" overall (26" box)*

**NOTE: Most Side Burners will require a 27-30" deep cabinet. Consult with your Account Manager for the correct size Side Burner Cabinet for your specified Appliances.*

Available Modifications:

Extend Side Panel (L/R)	+12"
Increase Height	+6"
Decrease Width	-3"
Increase Depth	+12"
Decrease Depth	-3"



Side View



3-D View

Visit www.werever.com to view available colors and door styles for all cabinets.

All Werever Outdoor Cabinets are constructed from solid, 3/4" high-density polyethylene.

Specification Sheet

Grill Pedestal Cabinet with Door

Available Models:

GP-9	1 Door
GP-12	1 Door
GP-15	1 Door
GP-18	1 Door
GP-21	2 Door
GP-24	2 Door
GP-27	2 Door
GP-30	2 Door
GP-33	2 Door
GP-36	2 Door
GP-39	2 Door
GP-42	4 Door
GP-45	4 Door
GP-48	4 Door



Grill Pedestal Cabinets provide functional storage and added support to carry the weight of a variety of grill and smoker models. Many projects include Kamado-style grills and smokers, and a Grill Pedestal Cabinet positioned below your kamado-style grill allows you to incorporate this unit as a part of your outdoor kitchen.

Every Grill installed in, on or near a Werever Cabinet requires an Insulating Jacket for combustible enclosures from the Grill Manufacturer, or appropriate clearance to combustible materials. Consult with your Account Manager for the correct use and size of Grill Pedestal Cabinet.

Top View

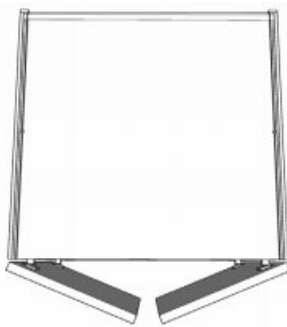

Front View

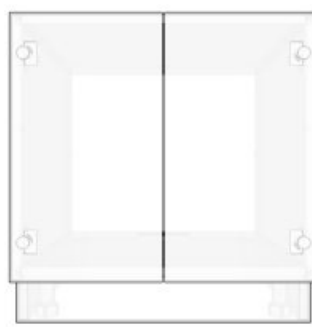

Standard Height: 24.75" overall (21" box)
Standard Depth: 24" overall (23" box)

Available Modifications:

Extend Side Panel (L/R)	+12"
Increase Height	+10"
Decrease Height	-9"
Decrease Width	-3"
Increase Depth	+15"
Decrease Depth	-9"

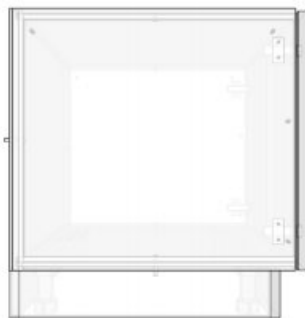

Side View



3-D View

**NOTE: Special modifications can be made to the height and depth of many Grill Pedestal Cabinet models to create Bench Seating that coordinates with your Outdoor Kitchen. Add custom seat cushions made by your local upholsterer for comfortable and functional seating.*

Visit www.werever.com to view available colors and door styles for all cabinets.

All Werever Outdoor Cabinets are constructed from solid, ¾" high-density polyethylene.

Specification Sheet

Grill Pedestal Cabinet with Drawers

Available Models:

GP-9-D	2 Drawers
GP-12-D	2 Drawers
GP-15-D	2 Drawers
GP-18-D	2 Drawers
GP-21-D	2 Drawers



Grill Pedestal Cabinets provide functional storage and added support to carry the weight of a variety of grill and smoker models. Many projects include Kamado-style grills and smokers, and a Grill Pedestal Cabinet positioned below your kamado-style grill allows you to incorporate this unit as a part of your outdoor kitchen. The Pedestal Cabinet with Drawers adds extra functionality to your design plan, providing storage for smaller items including utensils, grill tools, foil and more.

Every Grill installed in, on or near a Werever Cabinet requires an Insulating Jacket for combustible enclosures from the Grill Manufacturer, or appropriate clearances to combustible materials. Consult with your Account Manager for the correct use and size of Grill Pedestal Cabinet.

Top View

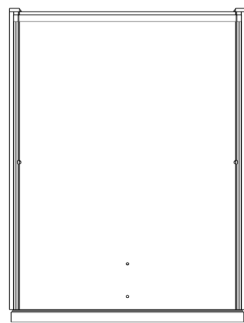

Front View



Standard Height: 24.75" overall (21" box)
Standard Depth: 24" overall (23" box)

Available Modifications:

Extend Side Panel (L/R)	+12"
Decrease Height	-9"
Decrease Width	-3"
Increase Depth	+15"

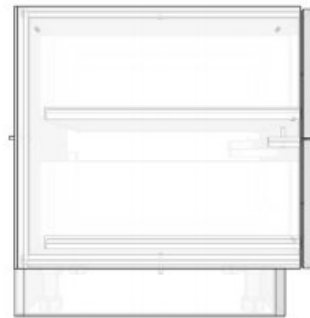

Side View



3-D View

**NOTE: Special modifications can be made to the height and depth of many Grill Pedestal Cabinet models to create Bench Seating that coordinates with your Outdoor Kitchen. Add custom seat cushions made by your local upholsterer for comfortable and functional seating.*

Visit www.werever.com to view available colors and door styles for all cabinets.

All Werever Outdoor Cabinets are constructed from solid, ¾" high-density polyethylene.

Specification Sheet

Built-In Appliance Pedestal Cabinet

Available Models:

BAP-24	2 Doors
BAP-27	2 Doors
BAP-30	2 Doors
BAP-33	2 Doors
BAP-36	2 Doors

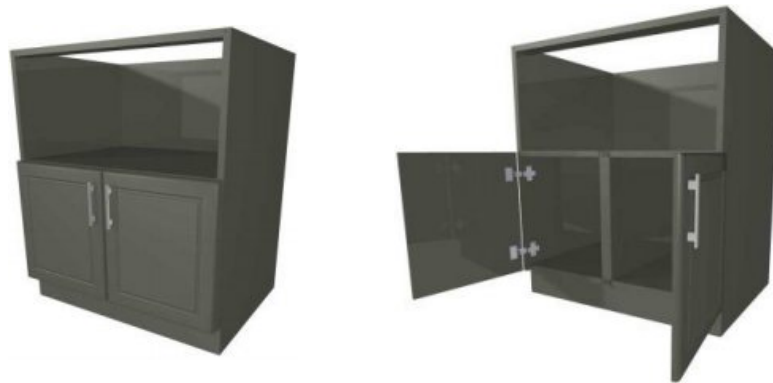

The Built-In Appliance Pedestal Cabinet provides functional storage and added support to carry the weight of a variety of appliances. The most common use of this cabinet is with Kamado-style grills. The front stretcher and raised sides allow for countertop to surround the unit for a true built-in application. The open space in this cabinet may also be used to house a microwave or other small appliance for easy access under the countertop.

Every Grill installed in, on or near a Werever Cabinet requires maintaining appropriate clearances to combustible materials. Consult with your Account Manager for the correct use and size of the Built-In Appliance Pedestal Cabinet.

Top View

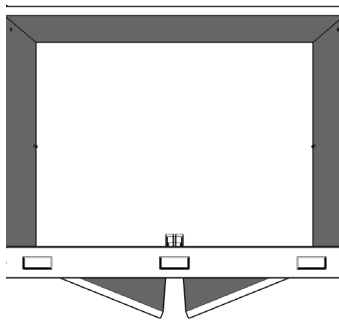

Front View

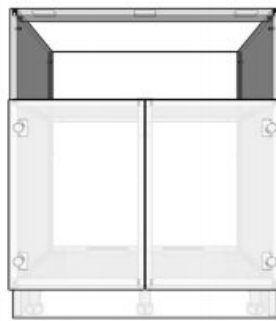

Standard Height: 34.75" overall (31" box)
Standard Depth: 24" overall (23" box)

Available Modifications:

Extend Side Panel (L/R)	+12"
Increate Height	+6"
Decrease Height	-12"
Decrease Width	-3"
Increase Depth	+15"
Decrease Depth	-3"

**NOTE: The height of the pedestal within this cabinet can be increased and decreased to accommodate the height of what is being stored or installed in the open area above storage.*

Side View

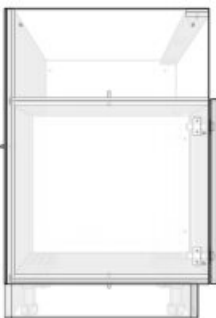

3-D View



Visit www.werever.com to view available colors and door styles for all cabinets.

All Werever Outdoor Cabinets are constructed from solid, ¾" high-density polyethylene.

Specification Sheet

Blind Base Corner Cabinet

Available Models:

BBC-36 1 Door R/L
BBC-42 1 Door R/L

*Any width available from
36 Inch to 42 Inch, and
in any fraction of an
inch.*



Blind Base Corner Cabinets provide extra storage in what may otherwise be dead space in the corner of your project. This cabinet includes a set-back adjustable shelf so you may store both taller and shorter items. If your project layout has a corner, ask your Account Manager to maximize storage with a Blind Base Corner Cabinet.

Top View

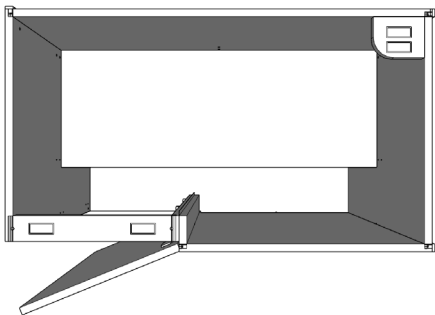

Front View

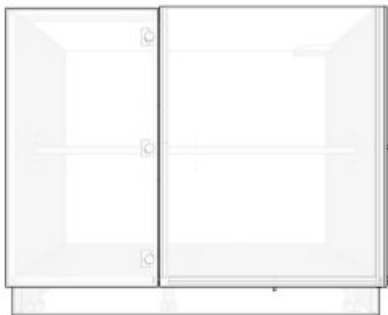

Standard Height: 34.75" overall (31" box)
Standard Depth: 24" overall (23" box)

Available Modifications:

Extend Side Panel (L/R)	+12"
Increase Height	+6"
Decrease Height	-6"
Decrease Width	-6"
Increase Depth	+12"
Decrease Depth	-9"



Side View



3-D View

Visit www.werever.com to view available colors and door styles for all cabinets.

All Werever Outdoor Cabinets are constructed from solid, 3/4" high-density polyethylene.

Specification Sheet

Diagonal Corner Cabinet

Available Models:

DCC-36x36	1 Door	R/L
DCC-36x39	1 Door	R/L
DCC-39x36	1 Door	R/L
DCC-39x39	1 Door	R/L

*Size of Cabinet determined by depth of adjacent cabinets.
Consult with your Account Manager for the correct size.*

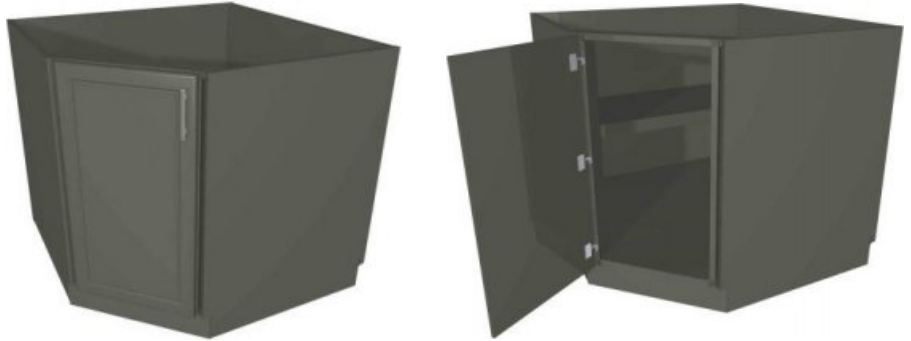

Diagonal Corner Cabinets maximize accessibility and storage space in a larger corner. If space allows for this cabinet in your design plan, you will benefit from full access to your corner through the door set on a 45-degree angle, and multiple options for storing all sizes of items. This cabinet includes one adjustable shelf.

Top View

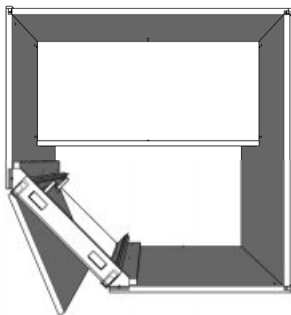

Front View



Standard Height: 34.75" overall (31" box)
Standard Depth: 24" overall (23" box)

Available Modifications:

Increase Height +6"
Decrease Height -6"

Special Modification:

Request a Diagonal Corner Pedestal Cabinet for your design if you would like your Kamado-style smoker in the corner. The Diagonal Corner Pedestal Cabinet is lowered to 24.75" overall height (modified height available) and includes additional support for your Kamado.

Side View

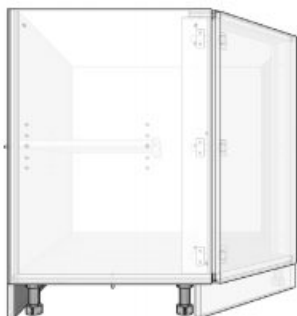

3-D View



Reference Models:

DCC-36-36-PEDESTAL, DCC-36-39-PEDESTAL, DCC-39-36-PEDESTAL, DCC-39-39-PEDESTAL

Visit www.werever.com to view available colors and door styles for all cabinets.

All Werever Outdoor Cabinets are constructed from solid, $\frac{3}{4}$ " high-density polyethylene.

Specification Sheet

Bi-Level Cabinets (Bar Cabinets)

Available Models:

Add “BL-” to the front of any Werever Cabinet model to make it Bi-Level, including:

Full Height Door Cabinets
Base Cabinets with Top Drawer
Sink Base Cabinets
4-Drawer Base Cabinets
Pull-Out Trash Cabinets
Grill Cabinets
Side Burner Cabinets
Blind Base Cabinets
LP Tank Cabinets
Open Base Cabinets
Refrigerator End Panels



Bi-Level Cabinets allow you to create a bar section without building a retaining/pony wall. This cabinet has a 4.5” deep section integrated at back and rises 6” above the working surface (standard bar height). Bi-Level Cabinets are built as a single structural unit with no seams in the cabinet sides for strength and structural integrity at the sides and bar section.

The Bi-Level Cabinet design is available for all standard Werever Cabinets. Complete the look with Finished Back Panels in either plain or with decorative detail upgrade.

Top View

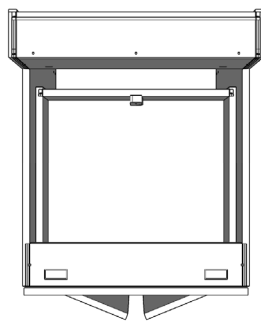

Front View

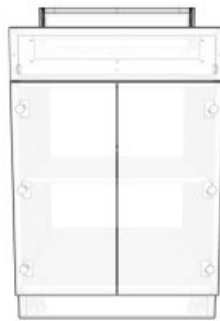

Standard Cabinet Depth: 28.5” overall
(27.5” box)
Grill Cabinet Depth: 31.5” overall
(30.5” box)

Available Modifications:

Most modifications available on standard cabinets are also available with Bi-Level Cabinets. Consult with your Account Manager for additional information.



Side View



3-D View

Visit www.werever.com to view available colors and door styles for all cabinets.

All Werever Outdoor Cabinets are constructed from solid, ¾” high-density polyethylene.

WEREVER OUTDOOR CABINETRY



Specification Sheet

Wall Cabinet

Available Models:

Single Door (R/L)

12" Tall W-912
W-1212
W-1512
W-1812

15" Tall W-915
W-1215
W-1515
W-1815

18" Tall W-918
W-1218
W-1518
W-1818

21" Tall W-921
W-1221
W-1521
W-1821

24" Tall W-924
W-1224
W-1524
W-1824

30" Tall W-930
W-1230
W-1530
W-1830

36" Tall W-936
W-1236
W-1536
W-1836

42" Tall W-942
W-1242
W-1542
W-1842

Double Door

12" Tall W-2112
W-2412
W-2712

15" Tall W-2115
W-2415
W-2715

18" Tall W-2118
W-2418
W-2718

21" Tall W-2121
W-2421
W-2721

24" Tall W-2124
W-2424
W-2724

30" Tall W-2130
W-2430
W-2730

36" Tall W-2136
W-2436
W-2736

42" Tall W-2142
W-2442
W-2742



Wall Cabinets increase the amount of storage in your outdoor kitchen when structural wall space is available. Wall Cabinets taller than 18" include adjustable shelving for storage flexibility. Werever manufactures Wall Cabinets with a standard depth of 15 Inches, to not only accommodate larger plates and other items, but to also accommodate reach over the deeper base cabinets and larger appliances typical in an Outdoor Kitchen.

Standard Depth: 15" overall (14" box)

Available Modifications:

Any width available from 9 Inch to 27 Inch, and in any fraction of an inch.

Any height available from 12 Inch to 42 Inch, and in any fraction of an inch.

Top View

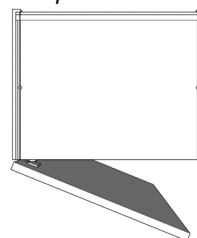

Front View

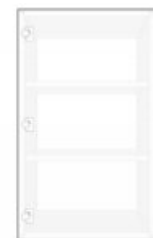

Side View



3-D View

Visit www.werever.com to view available colors and door styles for all cabinets.

All Werever Outdoor Cabinets are constructed from solid, $\frac{3}{4}$ " high-density polyethylene.

Specification Sheet

Open Shelf Wall Cabinet

Available Models:

12" Tall	OSW-912 OSW-1212 OSW-1512 OSW-1812	12" Tall	OSW-2112 OSW-2412 OSW-2712
15" Tall	OSW-915 OSW-1215 OSW-1515 OSW-1815	15" Tall	OSW-2115 OSW-2415 OSW-2715
18" Tall	OSW-918 OSW-1218 OSW-1518 OSW-1818	18" Tall	OSW-2118 OSW-2418 OSW-2718
21" Tall	OSW-921 OSW-1221 OSW-1521 OSW-1821	21" Tall	OSW-2121 OSW-2421 OSW-2721
24" Tall	OSW-924 OSW-1224 OSW-1524 OSW-1824	24" Tall	OSW-2124 OSW-2424 OSW-2724
30" Tall	OSW-930 OSW-1230 OSW-1530 OSW-1830	30" Tall	OSW-2130 OSW-2430 OSW-2730
36" Tall	OSW-936 OSW-1236 OSW-1536 OSW-1836	36" Tall	OSW-2136 OSW-2436 OSW-2736
42" Tall	OSW-942 OSW-1242 OSW-1542 OSW-1842	42" Tall	OSW-2142 OSW-2442 OSW-2742



Wall Cabinets increase the amount of storage in your outdoor kitchen when structural wall space is available. Open Shelf Wall Cabinets provide the opportunity to put your items on display, or support baskets and bins for added functional storage of items you will use in the outdoor environment.

Standard Depth: 14" overall (14" box)

Available Modifications:

Any width available from 9 Inch to 27 Inch, and in any fraction of an inch.

Any height available from 12 Inch to 42 Inch, and in any fraction of an inch.

Top View

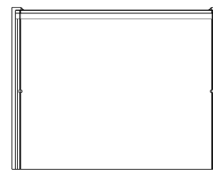

Front View

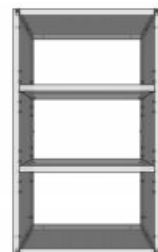

Side View



3-D View

Visit www.werever.com to view available colors and door styles for all cabinets.

All Werever Outdoor Cabinets are constructed from solid, $\frac{3}{4}$ " high-density polyethylene.

Specification Sheet

Blind Corner Wall Cabinet

Available Models:

BWC-36-24	R/L	1 Door
BWC-36-30	R/L	1 Door
BWC-36-36	R/L	1 Door
BWC-36-42	R/L	1 Door

BWC-42-24	R/L	2 Door
BWC-42-30	R/L	2 Door
BWC-36-36	R/L	2 Door
BWC-36-42	R/L	2 Door



Blind Corner Wall Cabinets provide extra storage in what may otherwise be dead space in the corner of your project. This cabinet includes an adjustable shelf for functional and flexible storage. If your project layout has a corner, ask your Account Manager to maximize overhead storage space with a Blind Corner Wall Cabinet.

Top View

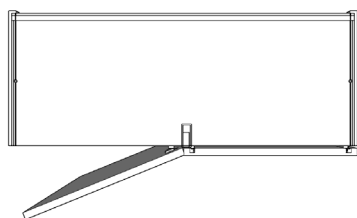

Front View

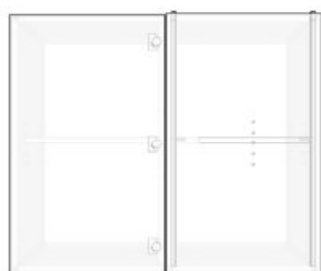

Available Modifications:

Any height available from 18 Inch to 42 Inch, and in any fraction of an inch.

Side View



3-D View



Visit www.werever.com to view available colors and door styles for all cabinets.

All Werever Outdoor Cabinets are constructed from solid, $\frac{3}{4}$ " high-density polyethylene.

Specification Sheet

Wall Diagonal Corner Cabinet

Available Models:

WDC-18x24x24	1 Door	R/L
WDC-21x24x24	1 Door	R/L
WDC-24x24x24	1 Door	R/L
WDC-27x24x24	1 Door	R/L
WDC-30x24x24	1 Door	R/L
WDC-33x24x24	1 Door	R/L
WDC-36x24x24	1 Door	R/L
WDC-39x24x24	1 Door	R/L
WDC-42x24x24	1 Door	R/L

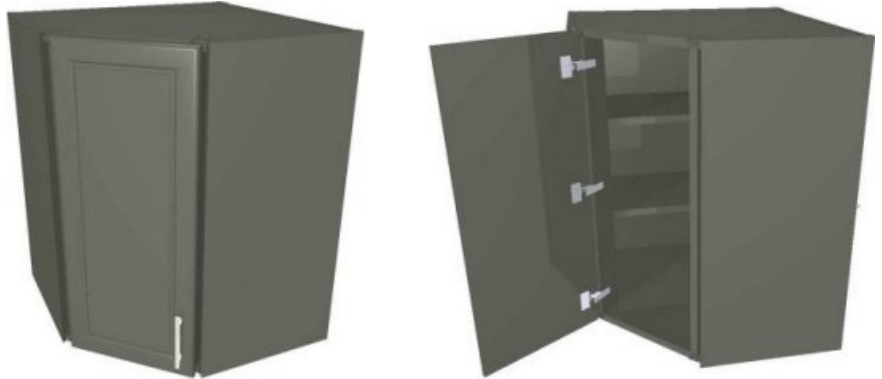

Wall Diagonal Corner Cabinets maximize accessibility and storage space in a corner. If space allows for this cabinet in your design plan, you will benefit from full access to your corner through the door set on a 45-degree angle. The Diagonal Wall Corner Cabinet includes either one or two adjustable shelves depending on cabinet height.

Top View

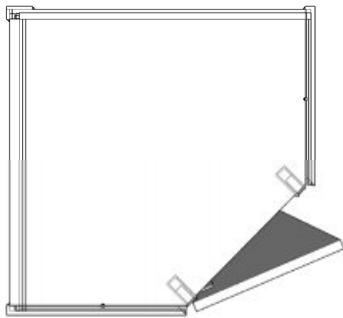

Front View

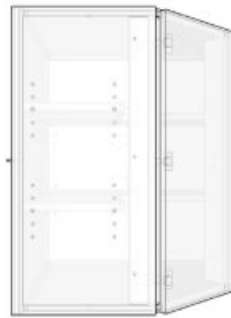

Available Modifications:

Any height available from 18 Inch to 42 Inch, and in any fraction of an inch.

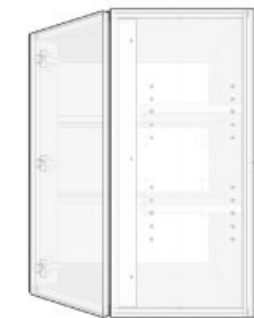

Side View



3-D View

Visit www.werever.com to view available colors and door styles for all cabinets.

All Werever Outdoor Cabinets are constructed from solid, $\frac{3}{4}$ " high-density polyethylene.

Specification Sheet

Pantry Cabinet

Available Models:

PC1860	2 Door	R/L
PC1872	2 Door	R/L
PC1884	2 Door	R/L
PC2460	4 Door	--
PC2472	4 Door	--
PC2484	4 Door	--

Any width available from 18 Inch to 24 Inch, and in any fraction of an inch.

Any height available from 60 Inch to 84 Inch, and in any fraction of an inch.



Pantry Cabinets multiply the amount of storage space in your outdoor kitchen and may become one of the most functional storage solutions in your space. Adjustable shelving comes standard; add pull-out trays for even more versatility. Please note, a center, fixed shelf is critical to the structural integrity of this cabinet model and cannot be removed. For taller items such as brooms and rakes, please consult with your Account Manager for possible solutions.

Top View

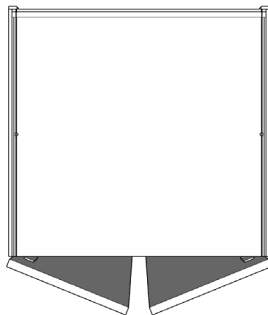

Front View



Standard Depth: 24" overall (23" box)

Available Modifications:

Extend Side Panel (L/R)	+12"
Decrease Height	-12"
Decrease Width	-6"
Increase Depth	+6"
Decrease Depth	-6"
Add Shelf	+2
Add Pull-Out Tray	+5

Special Modification:

Pantry Cabinet width may be reduced to 12" wide, and overall height may be reduced to 48" tall (44.25").

NOTE: Must be secured to rear wall.

Visit www.werever.com to view available colors and door styles for all cabinets.

Side View



3-D View



All Werever Outdoor Cabinets are constructed from solid, 3/4" high-density polyethylene.

WEREVER OUTDOOR CABINETRY



Specification Sheet

Corbels



Available Models:

- CORB-A Arched Corbel
- CORB-D Deluxe Corbel
- CORB-S Standard Corbel

Corbels are multifunctional for both aesthetics and function. Corbels may be used on the back side of an island or free-standing layout of cabinetry to help support your countertop or bar top overhang for seating, or even on the end of a run for added countertop surface beyond the cabinets if space allows. Corbels are constructed from the same color of HDPE as your cabinetry order. Choose from three styles.



Standard Size: 9" Deep, overall
10" High, overall
2.5" Wide, overall

Available Modifications:

None Available.

NOTE: Please consult with your Countertop Fabricator and Installer for the optimal method of installation of corbels to properly support your countertop or bar top overhang. Additional reinforcement may be required in the field and will not be determined or provided by Werever.

Example of Installed Deluxe Corbel

Photo also features Black color, and Full V-Groove Decorative Upgrade Detail on Finished Back Panels.

Visit www.werever.com to view available colors and door styles for all cabinets.

All Werever Outdoor Cabinets are constructed from solid, $\frac{3}{4}$ " high-density polyethylene.

Specification Sheet

False Cabinet

Available Models:

False-B-9	1 Door	R/L
False-B-12	1 Door	R/L
False-B-15	1 Door	R/L
False-B-18	1 Door	R/L
False-B-21	2 Door	--
False-B-24	2 Door	--
False-B-27	2 Door	--
False-B-30	2 Door	--
False-B-33	2 Door	--
False-B-36	2 Door	--

Any width available from 9 Inch to 36 Inch, and in any fraction of an inch.

False Cabinets allow access to what may otherwise be dead space in a cabinet run. Use a False Cabinet in your project to conceal the area where you have a spigot on the wall but maintain the aesthetics of the same base cabinets at the front of your cabinet run. Column or post interrupting where you want to install cabinets? A False Cabinet can be used for uninterrupted design and functionality. Consult with your Account Manager to find out if a False Cabinet may be the solution in your project.



Top View

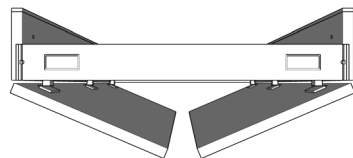

Front View



Standard Height: 34.75" overall (31" box)
Standard Depth: 6" overall (5" box)

Available Modifications:

Extend Side Panel (L/R)	+12"
Increase Height	+6"
Decrease Height	-16"
Decrease Width	-3"

Special Modification:

Available as small as 7" wide.

Side View



3-D View



Visit www.werever.com to view available colors and door styles for all cabinets.

All Werever Outdoor Cabinets are constructed from solid, $\frac{3}{4}$ " high-density polyethylene.

Specification Sheet

Fillers

Base Filler (BF-)



Werever's Fillers have a return piece for you to easily connect the filler to the side of cabinet using stainless steel binding posts. Use a Base Filler between a cabinet and a wall to ensure your cabinet door will clear and open beyond 90 degrees. Base Fillers can be trimmed and scribed once cabinets are level, square and plumb.

Available 1" wide up to 12" wide (L/R).

Double Return Filler (BFDR-)



The Base Filler with Double Return is used between two cabinets; two returns allow you to connect the filler to a cabinet on each side. Double Return Fillers may not be trimmed during install and should be ordered to fit. Use this filler style if spanning an area with a post or other architectural feature or obstruction.

Available 3" wide up to 9" wide.

Refrigerator Filler (RF-)



Refrigerator Fillers are used between a Cabinet and an Appliance such as an under-counter Refrigerator, Ice Maker, or Dishwasher, and particularly if clearance is required for a door or drawer to open. This filler may not always be required, and your Account Manager and Designer will assist you with the correct application and use.

Available 1" wide up to 6" wide (L/R).

Base Corner Filler (BCF-)



Rather than having to trim and mitre fillers at a dead corner, Werever offers a Base Corner filler precisely sized to fill the corner in your project. A minimum of 2"-3" is recommended at a dead corner with standard cabinets, and minimum 5"-6" is recommended if a Grill or Side Burner is positioned to the right or left of the corner.

Available 2" x 2", up to 12" x 12"

Wall Filler (WF-)



Wall Fillers have the same return piece as all base fillers to connect to the side of the cabinet box, and also have a bottom piece to conceal the underside of the space between your wall and cabinet at the splash level. Use a Wall Filler between the cabinet and wall to allow your cabinet door to open the full 100-degree swing of the hinges.

Available 1" wide up to 6" wide (L/R).

Wall Corner Filler (WCF-)



Wall Corner Fillers provide extreme ease for installation. Two wall fillers join to form one and cut specifically to your project so there is no need to fit and trim in the field, and a precisely fabricated bottom panel conceals the underside of the void in the corner at the splash level. The 3" x 3" size allows for doors to open clear of the adjoining run.

Available 3" x 3".

All Fillers are sized to the height of your base, wall, or pantry cabinets. Fillers can be used in a variety of ways to give you the perfect, custom fit. Consult with your Account Manager on the best use and style of fillers.

Visit www.werever.com to view available colors and door styles for all cabinets.

All Werever Outdoor Cabinets are constructed from solid, ¾" high-density polyethylene.

Specification Sheet

Refrigerator End Panel

Available Models:

REP-3 R/L
REP-3.5 R/L
REP-4 R/L
REP-4.5 R/L
REP-5 R/L
REP-5.5 R/L
REP-6 R/L

Any REP width available from 3 Inch to 6 Inch, and in any fraction of an inch.

Standard Height: 34.75" overall
(31" box)

Standard Depth: 24" overall
(23" box)

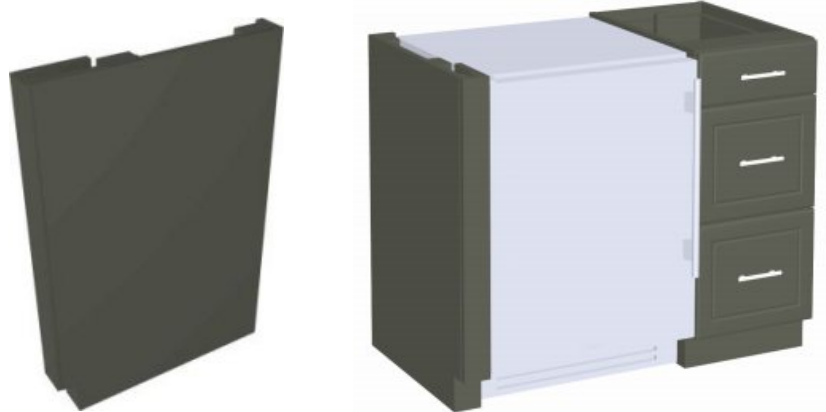

Refrigerator End Panels are designed to cap the end of a run of base cabinets when an under-counter appliance, such as refrigerator, ice maker, or dishwasher, is planned to be installed on an end. Refrigerator End Panels are structural, will assist in supporting the weight of your countertop, and have leveling legs.

Finished Return Panel

Available Models:

FRP-3 R/L

FRP width may be increased upon request, if required.

Standard Height: 34.75" overall
(31" box)

Standard Depth: 24" overall
(23" box)

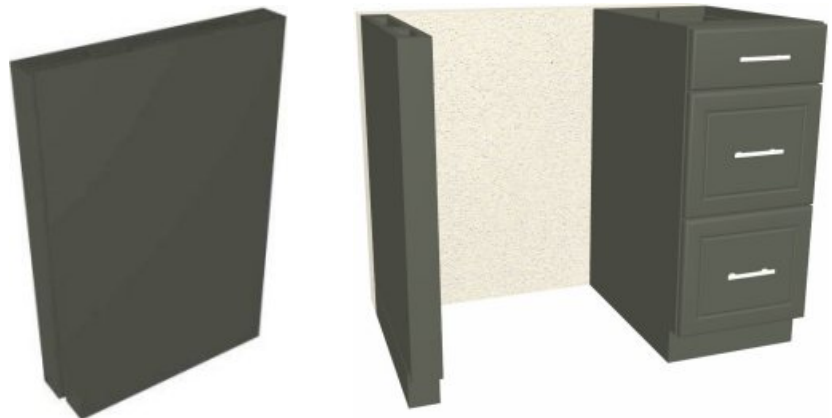

Finished Return Panels are designed with two solid, finished panel sides to cap the end of an open space where both sides of the panel will be visible (for example, a seating area or flexible open space). Finished Return Panels are structural, will assist in supporting the weight of your countertop, and have leveling legs.

Visit www.werever.com to view available colors and door styles for all cabinets.

All Werever Outdoor Cabinets are constructed from solid, $\frac{3}{4}$ " high-density polyethylene.

Specification Sheet

Corner Posts

Available Models:

Standard Corner Posts:

CP-90	4" x 4"
CP-45	6" x 6"

Bi-Level Corner Posts:

BLCP-90	12" x 12"
BLCP-45	6" x 6"

There are times when additional structural support is needed, for example when attaching finished back panels to cabinet installations or in voided areas. Werever builds Corner Posts that use the same leveling legs as their cabinets to simplify installation and allow toe kick pieces to be attached. Your design may call for these pieces which greatly reduce installation difficulty and improve the structural integrity of the finished project.

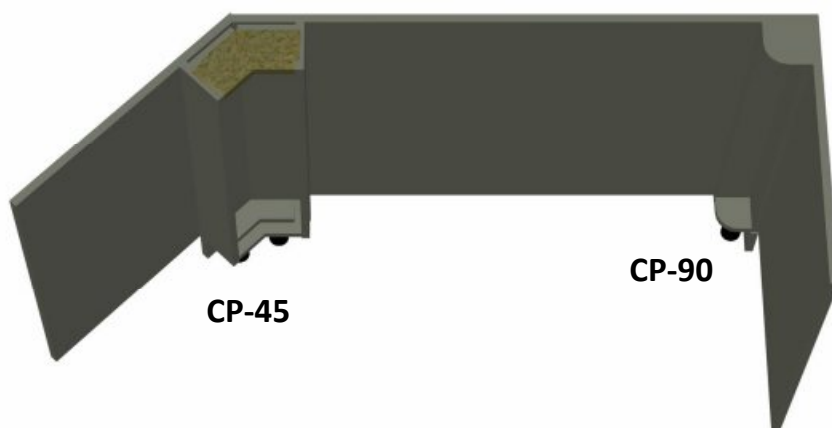

Available Modifications:

Height can be modified to coordinate with your Cabinet height.

NOTE: Your Account Manager and Designer will assist you with the recommended placement of Corner Posts in your design plan. Please also consult with your Installer and Countertop Fabricator regarding the required support needed for your project installation.

Example Rendering of Corner Posts

Rendering also features Werever's Decorative Back Panels (DBP-) used in island or other free-standing designs.

Visit www.werever.com to view available colors and door styles for all cabinets.

All Werever Outdoor Cabinets are constructed from solid, $\frac{3}{4}$ " high-density polyethylene.

Specification Sheet

Decorative Back Panels

Available Models:

DBP-STD	31" Tall
DBP-BILEV	37" Tall
DBP-BH	42" Tall
DBP-TALL	48" Tall

Decorative Back Panels are available up to 72" wide (solid color), or up to 53" wide (woodgrain upgrade).

Any height available up to 48" tall, in any fraction of an inch.

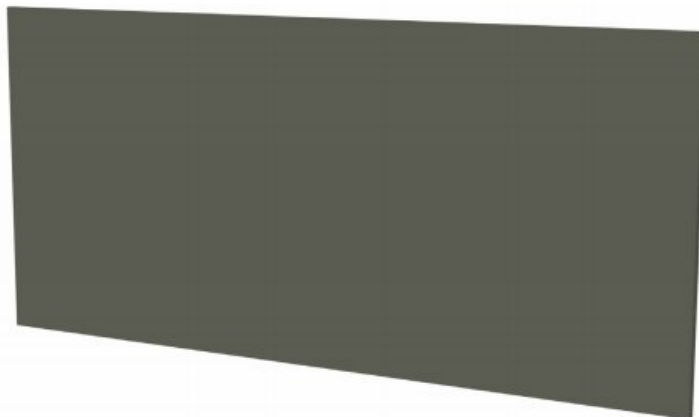

Decorative Back Panels finish the back side of any island or other free-standing cabinetry installation with the same $\frac{3}{4}$ " thick HDPE material from which Werever Cabinets are constructed. Installation Hardware for Decorative Back Panels is provided with your order. Decorative Upgrades are available in Full V-Groove (beadboard-look) or to coordinate with your Upgraded Door Style selection.

Toe Kick

Available Models:

TK-6	5" Tall
------	---------

Toe Kick may be modified up to 10" Tall, as required.

Fixed 72" width.

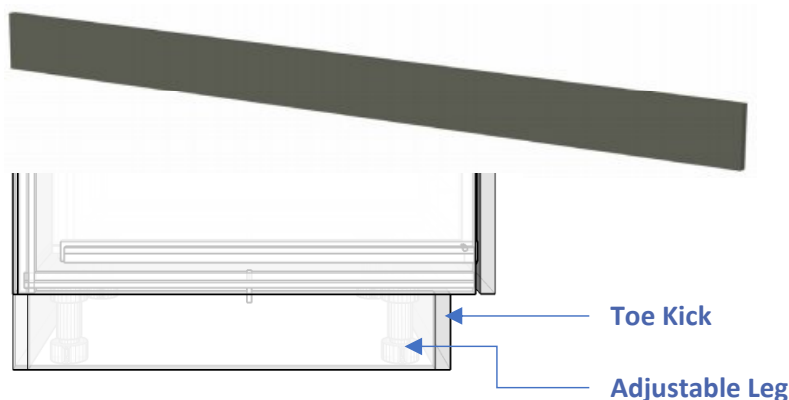

All Werever Cabinets install on adjustable legs, allowing for a level, square and plumb installation regardless of uneven floor surface or slope in your outdoor environment. Toe Kick material, of the same $\frac{3}{4}$ " thick solid HDPE material as the cabinetry, clips on these adjustable legs with clips provided with your order. Toe Kick is trimmed and ripped during installation for a perfect, finished fit at the floor line.

Visit www.werever.com to view available colors and door styles for all cabinets.

All Werever Outdoor Cabinets are constructed from solid, $\frac{3}{4}$ " high-density polyethylene.